

# Rosewood Phase 2, Maidstone, Kent

## 2 Bedroom FOG - Flat Over Garage

Plots 252 and 272

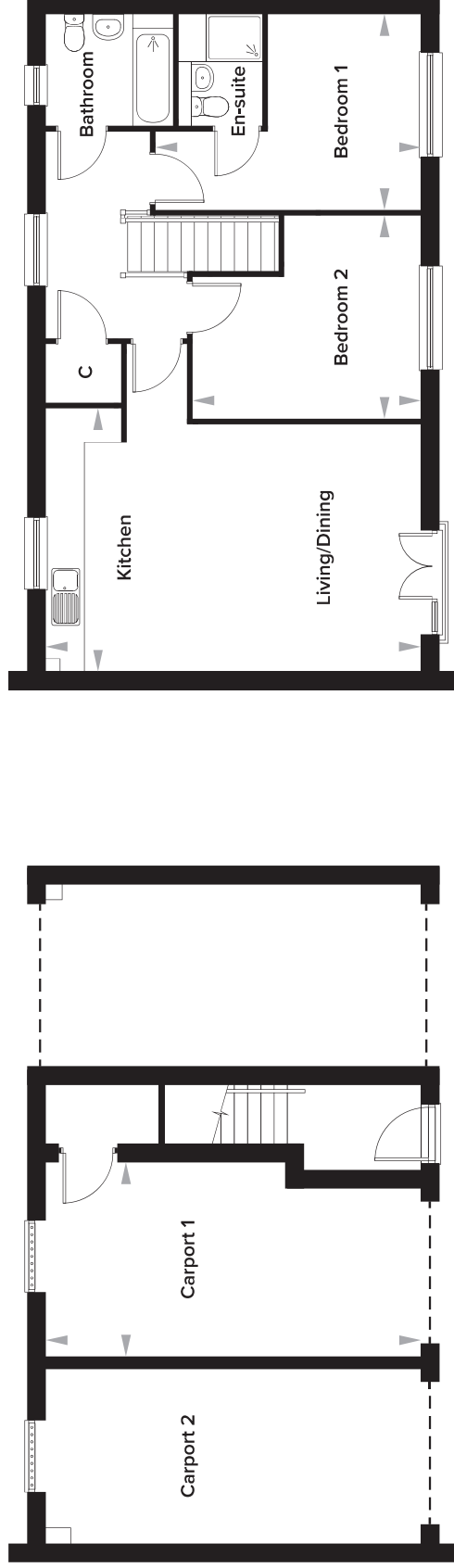

### Ground Floor

Carport 1 3.38m x 6.53m 11' 1" x 21' 5"

### First Floor

Kitchen/Living/Dining 4.59m x 6.48m 15' 1" x 21' 4"  
 Bedroom 1 3.38m x 4.60m 11' 1" x 15' 1"  
 Bedroom 1 En-suite 1.93m x 1.38m 6' 4" x 4' 6"  
 Bedroom 2 3.53m x 3.96m 11' 7" x 13' 0"  
 Bathroom 1.93m x 2.20m 6' 4" x 7' 3"

Please note: dimensions are approximate +/- 50mm and are not intended to be used for carpet sizes, appliance spaces or furniture items.