

Rosewood Phase 2, Maidstone, Kent

2 Bedroom FOG - Flat Over Garage

Plots 252 and 272

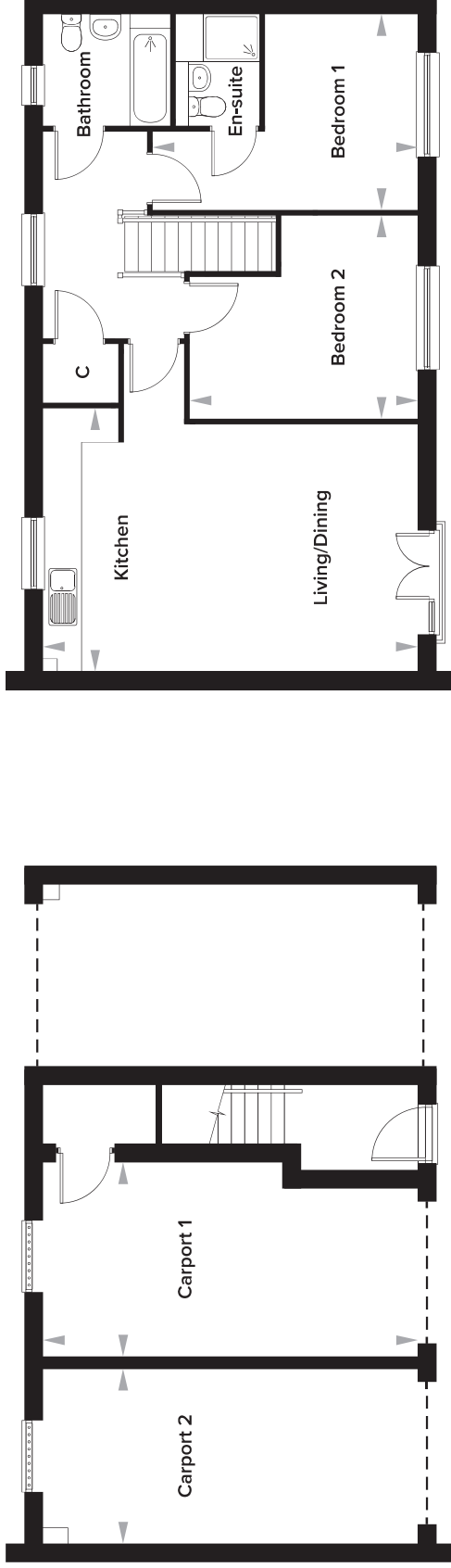

Ground Floor

Carport 1	3.38m x 6.53m	11' 1" x 21' 5"
Carport 2	3.05m x 6.53m	10' 0" x 21' 5"

First Floor

Kitchen/Living/Dining	4.59m x 6.48m	15' 1" x 21' 4"
Bedroom 1	3.38m x 4.60m	11' 1" x 15' 1"
Bedroom 1 En-suite	1.93m x 1.38m	6' 4" x 4' 6"
Bedroom 2	3.53m x 3.96m	11' 7" x 13' 0"
Bathroom	1.93m x 2.20m	6' 4" x 7' 3"

Please note: dimensions are approximate +/- 50mm and are not intended to be used for carpet sizes, appliance spaces or furniture items.