

PLOT 16 - 3 BEDROOM HOUSE (97.4m²)

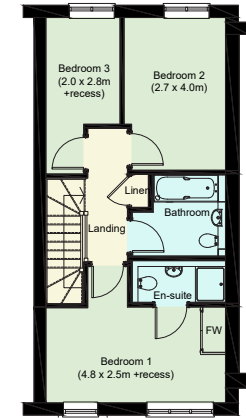

First Floor Plan

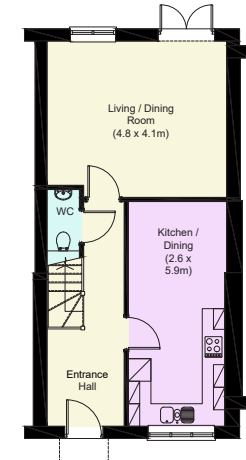

Ground Floor Plan

Computer generated imagery is included for guidance only. The properties may vary in terms of elevational design details, position, size and materials used.

Room	Metric	Imperial
Living / Dining	4800 x 4100mm	15' 09" x 13' 05"
Kitchen	2600 x 5900mm	08' 06" x 19' 04"
Bedroom 1	4800 x 2500mm	15' 09" x 08' 02"
Bedroom 2	2700 x 4000mm	08' 10" x 13' 01"
Bedroom 3	2000 x 2800mm	06' 07" x 09' 02"

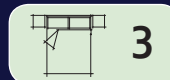

The 2 storey property offers contemporary living/dinning with fitted kitchen and integrated appliances.

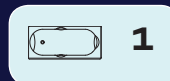

The ground floor comprises the fitted kitchen and separate living/ dining area with patio door to garden.



The first floor comprises three bedrooms and the family bathroom.

Dimensions are for guidance only and may vary.

SPECIFICATION



Kitchen

- Choice of designer worktops and units
- Chrome mixer tap to kitchen sink
- Stainless steel kitchen sink
- Recycle bin

Bathroom & En-suite

- Chrome towel rail
- Fitted mirror and shaver point

General

- Allocated parking spaces
- Private rear garden

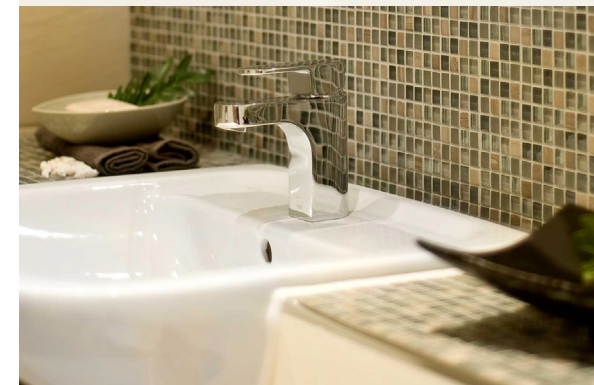

Interior photographs taken from previous Akehurst Homes developments.